

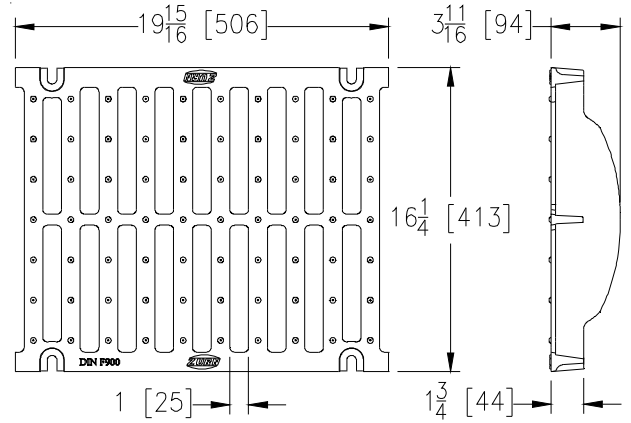

Z874-12

12" WIDE THROAT GRATES

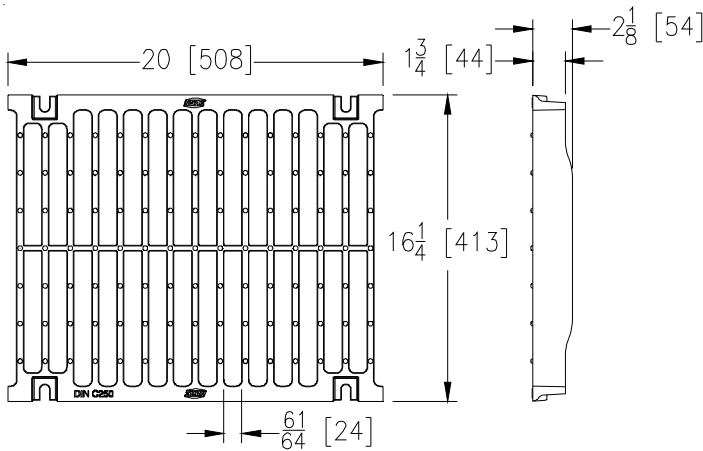

Please Check	Item No.
✓	13

GDC-USA -Galvanized Domestic Ductile Iron		
Material: Ductile Iron		
DIN Rating: Class C		
Weight: 29.00 # per ft.		
Open Area: 118 sq. in. per ft.		
ANSI Rating: Heavy-Duty		
Application: Heavy Vehicle & Truck		
Slot Width/Hole Size: .95"		
ADA	H-20	FAA
No	Yes	No

Please Check	Item No.
✓	14

GDF-USA -Galvanized Domestic Ductile Iron		
Material: Ductile Iron		
DIN Rating: Class F		
Weight: 39.8 # per ft.		
Open Area: 120 sq. in. per ft.		
ANSI Rating: Heavy-Duty		
Application: Heavy Vehicle, Truck & Conduit		
Slot Width/Hole Size: 1"		
ADA	H-20	FAA
No	Yes	Yes